



THE 1ST AEC World Tour
Soft Tennis Championships 2015
NONTHABURI THAILAND
Road to 15th World Cup

The Guide to

**“ The 1st AEC WORLD TOUR
SOFT TENNIS CHAMPIONSHIPS 2015 ”
NONTHABURI, THAILAND
(Royal Trophy Competition)**

1. **Name of Event:** The 1st AEC WORLD TOUR SOFT TENNIS CHAMPIONSHIPS 2015 : ROAD TO 15th WORLD CUP
2. **Period:** 30 March – 3 April 2015
3. **Place :** Nonthaburi,Thailand
4. **Organize by :** Soft Tennis Association of Thailand
5. **Tournament Adviser :** Mr.Kamthorn Intharapichai
The President of Thailand Soft Tennis Association
6. **Tournament Director :** Mr.Sorrachet Uayporn
E-Mail: softtennis_thailand@hotmail.com
7. **Competition Venue:** Impact Sports Club
Address: 101/3-4 Muangthong Thani,Changwattana Road
Pakkred District,Nonthaburi 11120
Phone-Number: (66-2)9807035
8. **Accommodation:** Novotel Bangkok Impact Hotel
Address: 94 Popular Road,Banmai Sub District,
Pakkred District , Don Muang, Nonthaburi 11120
Phone-Number: (66-2)8334888

9. Events & Schedule

- (1) Team Events
 - Men Team Competition
 - Women Team Competition
- (2) Individual Events
 - Men Singles
 - Women Singles
 - Men Doubles
 - Women Doubles
 - Mixed Doubles
- (3) Junior Singles Events
 - Boy's Singles Under 15 & Under 18
 - Girl's Singles Under 15 & Under 18

DATE	TIME	EVENT
29 March	14:00-17:00	Arrive in accommodation / Registration
	19:00-20:00	Manager's Meeting
30 March	08:00-09:00	Opening Ceremony
	09:00-18:00	Team Competitions for Men & Women
31 March	08:00-18:00	Team Competitions for Men & Women
1 April	08:00-18:00	Individual Singles (Round Robin)
2 April	08:00-18:00	Individual Doubles (Round Robin)
3 April	09:00-16:00	Quarter Final to Final Round
	17:00-18:00	Victory & Closing Ceremony
	19:00-21:00	Farewell Party
4 April	09:00-10:00	Departure

10. Eligibility

10.1) Participating players shall be those who have been approved by those respective National Soft Tennis Association/Federations which are the member Countries/regions (here in after called "countries") of the ASTF, in accordance with the constitution of the IOC, as players belonging to the respective organizations, and are primarily involved in the soft tennis competitions and other activities of the said countries. Also, they must meet the conditions for the participation in the competitions as described in item 15 of this guide. The players who play in the team events, which are competed

on a country basis, shall have the nationality of the countries they will represent.

10.2) Participating head of team and coaches shall be those who have been so approved by the respective organizations of the countries they will represent.

11. Entries

11.1) Each country shall comprise its men and women teams with a maximum of five (5) players respectively. And each country can sent more than 1 team

Each country shall be allowed to enter no maximum pairs each for individual events men's and women's (singles & doubles), and a minimum of three (3) and a maximum of five (5) players each for men's and women's team competitions. Each player shall be allowed to concurrently enter more than one event.

11.2) Each team shall be allowed to register, in addition to its players, a maximum of two (2) officials (1 coach and 1 team manager). Only a coach involved in the match in the team event shall be allowed to sit on the team bench.

11.3) Deadline dates for entries

The countries planning to participate in this Championship must send the original of their completed Entry by Name forms to the tournament director such that these arrive no later than 24:00 (local time) on Friday January 16, 2015 by e-mail. Completed Entry by Name forms must be submitted for each players and officials and must include all necessary information, including sex, date of birth and nationality, etc. with photos. Final Entry by e-mail with photos to be mail. Countries which plan to enter more than one player in each individual event must list them in the order of ability in their Entry by Name form.

11.4) Once the entries have been accepted, they shall not be allowed to change.

11.5) Address for entries:
softtennis_thailand@hotmail.com

** After registered, the tournament organizer will send back a confirmation of entries by email.

if you do not receive anything, kindly contact the tournament organizer at the number above as soon as possible.

12. Competition Rule & Relates Regulation

12.1) The competitions shall be conducted according to the rules of soft tennis approved by the ISTF, based on the constitution and regulations of the ISTF.

12.2) The official language for this event shall be English

13. Competition Methods & Decision of Ranking

The competition methods shall be decided by the CTSTA depending on the number of entries by event in principal. However, the competitions shall be conducted basically by the methods as follows :

(Individual Events)

(1) A tournament system shall be applied for men's and women's singles, mixed doubles, and men's and women's doubles matches.

(2) Classification matches aren't held.

(3) A doubles match shall be decided by the best of nine 9 games system , a singles match by the best of seven 7 games.

(Team Events)

(1) A tournament system shall be applied in men and women competition.

(2) In both men and women competitions, a tie shall be completed in the order of (1) 1st doubles (2) singles (3) 2nd doubles, totaling three(3) matches. The team, when it has won two (2) matches in a tie, shall be the winner of the tie, and the remaining one match shall not be played.

However, 3 matches shall be played at the occasion of first tie of each team.

14. Draw

The respective draw shall be determined by the Thailand Soft Tennis Association and respective draws for the Junior and individual events shall be decided by the organizer and announced at the manager's meeting to be held on Sunday 29th March 2015.

15. Ball & Other Equipment / Facilities

(1) Balls to be used for this event shall be selected and decided by the Thailand Soft Tennis Association among from those approved by the ISTF.

(2) Nets, net posts and other required equipment/facilities for competition which conform to the standards specified by the ISTF shall be used.

16. Medical Control

(1) A doping test shall be conducted in accordance with the regulations of the SAT.

(2) The test results shall be respected by all the participants.

17. Commendation

- (1) In each team event, The Winner team get the Royal Trophy, the prizes shall be awarded to the first, second and 2 third place winners.
All player in team get medals and certificates
- (2) In each individual event, prizes shall be awarded to the first, second and 2 third place winners.
player get medals and certificates
- (3) Commendations will be awarded to the winners in each finalist deciding tournament as follow

Team Event (Men & Women Team)

- 1) Winner :
 - Royal Trophy
 - Gold Medals for all players in the team (Including Coach and Team manager)
 - Certificates
 - Prize Money 600 US\$
- 2) Runner up :
 - Royal Trophy
 - Silver Medals for all players in the team (Including Coach and Team manager)
 - Certificates
 - Prize Money 300 US\$
- 3) Semi-Finalist :
 - Bronze Medals for every players in the team (Including Coach and Team manager)
 - Certificates
 - Prize Money 150 US\$

**** Prize Money Teams for this participants
must have a minimum of 10 Teams ****

if a player not fully, prize money ratio decreases

Individual Event (Men & Women)

- Singles, Doubles & Mixed Doubles

- 4) Winner :
 - Gold Medal
 - Certificate
 - Prize Money 400 US\$
- 5) Runner up :
 - Silver Medal
 - Certificate
 - Prize Money 200 US\$
- 6) Third Placed :
 - Bronze Medal
 - Certificates
 - Prize Money 100 US\$

Individual Event (Juniors)

- Boy's & Girls Singles Under 15 & Under 18

- 7) Winner :
 - Gold Medal
 - Certificate
 - Prize Money 150 US\$
- 8) Runner up :
 - Silver Medal
 - Certificate
 - Prize Money 100 US\$
- 9) Third Placed :
 - Bronze Medal
 - Certificates
 - Prize Money 50 US\$

All players and official will get the certificate for participants AEC World Tour 2015.

**** Prize money individual for this participants must have a minimum of 48 players for singles event, minimum of 24 pairs for doubles event & minimum of 16 players for junior singles event****

if a player not fully, prize money ratio decreases

18. Expenses

(1) Entry Fee

- Team Events entry = 170 US\$/Team
- Individual Events entry = 30 US\$/Player/Event
- Junior Events entry = 20 US\$/Player/Event

** All players and official will get the
dipoma for participants **

(2) Expense for hotel, meals & transportation

- Each person is charged for 70 US\$ per day for 3 meals ,
room & transportation
- Total is 350 US\$ from 30 March - 3 April 2015
- Those that will not stay at the official hotel
designated by the host organization will pay 45 US\$ per
person a day to the host organization

19. Manager's Meeting

A meeting for head of team and coaches from all participating countries will be held on March 29, 2015, when competition details will be disclosed.

20. Visas

If citizens of your country need visas, official invitation letter etc., do not hesitate to ask us for help, please as soon as possible, so that we will manage to go through all the necessary procedures.

21. Other

Each participating team is requested to advise its schedule of arrival and departure to/from Suvarnabhumi Airport, Bangkok (Date, Time, Airlines, Flight Number, etc.) to the tournament organizer not later than Saturday 21st February 2015. This information will be highly appreciate for transportation and other arrangements.

22. Security

To realize a smooth management and security of the event, ID cards shall be issued as identified.

Sample of ID cards' status

Function	Class	Function	Class
STAT Officials	S	Referees	R
Players	P	Head of Team	M
V.I.P.	V	Coaches	C
Press	N	Umpires	U



Mr.Kamthorn Intharapichai

The President Soft Tennis
Association of Thailand



Mr.Sorrachet Uayporn

Tournament Director

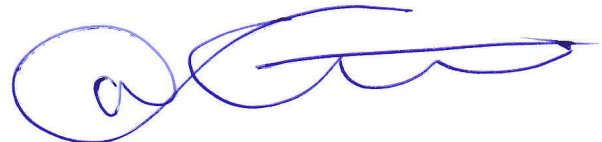

Mr.Pipat Tungittiplakorn

The Vice President Soft Tennis
Association of Thailand

COMPETITION VENUE
IMPACT SPORTS CLUB
(TOTAL 7 INDOOR HARD COURTS PLEXIPAVE SURFACE)

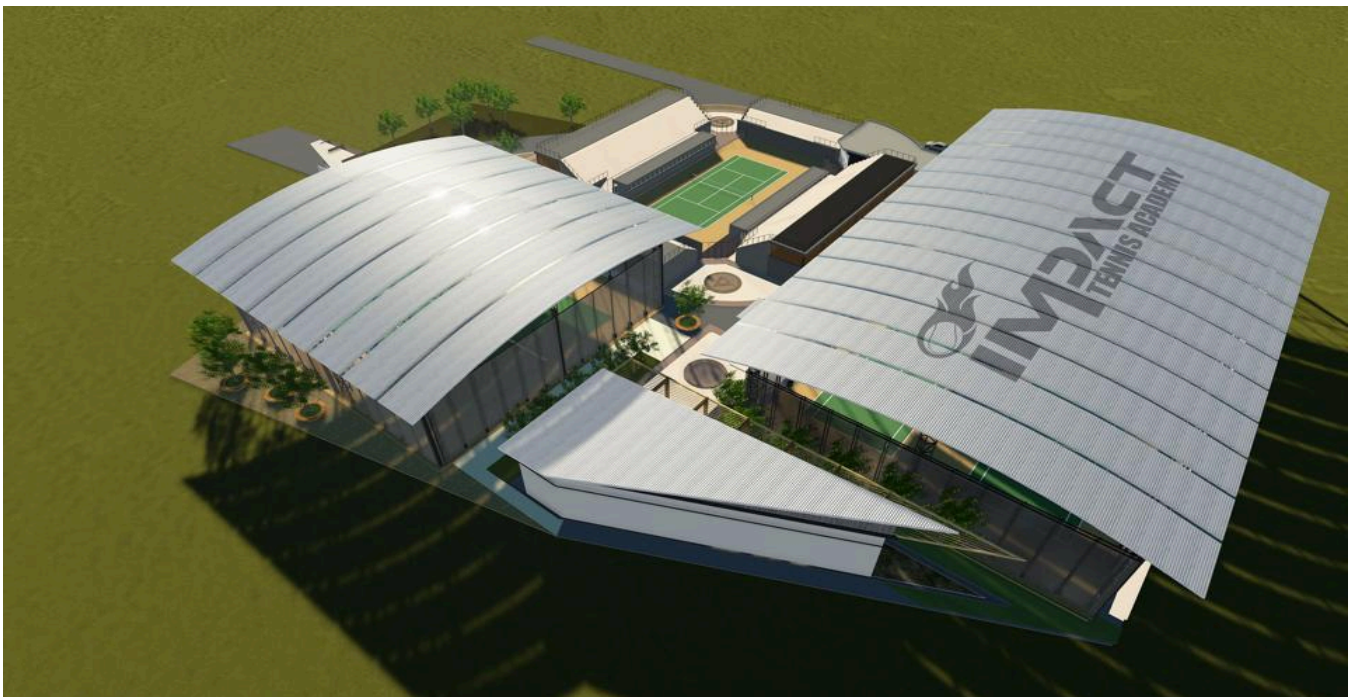

ACCOMMODATION : NOVOTEL BANGKOK IMPACT HOTEL

